

GFL/S Distribution Box Manual

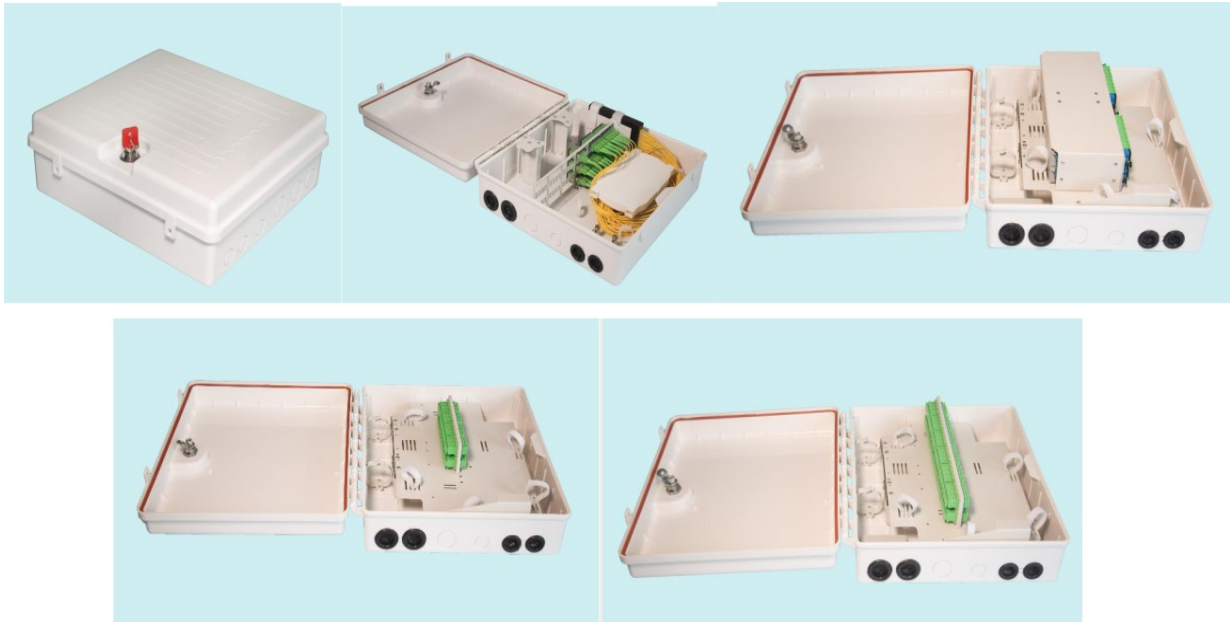

Introduction:

Plastic GFL/S splitter distribution box is used for the distribution connection of cable and fiber optic communication devices. It leads out the optic signal from drop cable to pigtails by splicing in the box (also for excess cables and adapters). It can be used for protective connection of cable and layout pigtails, and fiber optic terminations of optic access network. It's applicable for wall or pole mounted outside the building when cables already come to building in the FTTH project.

It also finishes straight through connection, Cable shall be spliced with indoor cable after stripping and coiling in the box, which finishes straight through connection, complying to traditional network transportation requirement.

The splitter distribution box can realize the functions of splitting, splicing, distribution and butterfly-like cable dispatch after cables to the floor in FTTH project. The bottom part is for incoming cable fixing, storage, splicing, and parking. The upper layer is for standard slot position for the installation of insert-style splitter. Cable strappings for splitters are optional.

Features:

- 1 Imported material, with aging resistant and ultra violet resistant
- 2 Special screw and key. Suitable for wall mount or pole mounted.
- 3 Working temperature: -40°C~+80°C; storage: -40°C~+80°C; 3、 Temporary pigtails storage area
- 4 Bi-layered structure, with bottom for splicing and upper layer for splitting and distribution
- 5 Turn-over middle panel, suitable for storage of butterfly cables, special lock device for cables
- 6 For splitting, 2/4 standard slot position for splitter, for 1:8,1:16,1:32 splitter.
For distribution,24/48/72 ports of adapters panel
- 7 Maximum 2 pcs of splice trays(expandable) for satisfying kinds of connection.

Type	Size (H×W×D) mm	cable ports	Max capacity
GFX/S-24D	340×350×120	12	24cores
GFX/S-48D	340×350×120	12	48cores
GFX/S-16D	340×350×120	12	1:16(1pcs) 1:8(2pcs)
GFX/S-32D	340×350×120	12	1:8(4pcs) 1:16(2pcs) 1:32(1pcs)
GFX/S-HS72D	340×350×120	12	1:32(2pcs)/72cores

Accessories:

1. expansion screw M6x70	4sets (wall mount)
Hose clamp $\phi 175 \sim \phi 197$	2pcs (pole mount)
Pole mount bracket	2pcs (pole mount)
M5x10 round head bolt	6pcs (pole mount)
2. heat think tube L=60	2/4/24/48pcs (16D/32D/24D/48D)
3.cable clamp $\phi 13 \sim \phi 19$	2pcs
4. M2x5 round head bolt	4/8/48/96 pcs (16D/32D/24D/48D)
5. cable tie 3x100	6pcs
6.fiber protective tube	0.5 meter

